

abbotFox



Aldermann McGee Gardens, Great Yarmouth  
*£199,950*

“

We are a team of genuine individuals who hold a deep passion for both property and marketing. Collectively, we bring over 70 years of experience in the property market of Norfolk and Suffolk. Our affection for both counties runs deep, and we are enthusiastic about sharing our passion with you.

Colin McKenzie | **Branch Partner**







## THE DETAIL \_\_\_\_\_

abbotFox Land & New Homes presents this brand new, mid terraced property. Built by renowned builders G & C homes who have over 50 years of experience of developing fantastic new homes in the local area. Situated in the vibrant coastal Town of Great Yarmouth, this home represents a fantastic opportunity for any growing family with a flexible layout and stylish finish throughout.

The ground floor comprises; an inviting entrance hall, WC, modern kitchen and generous lounge diner, that opens onto the enclosed rear gardens. The first floor offers three generous bedrooms and family bathroom.

Externally, the property allows for a private enclosed rear garden, and parking to the front of the property.

An internal viewing comes highly recommended.







## THE HIGHLIGHTS \_\_\_\_\_

- Four remaining units in this phase, starting price £199,950
- Terraced house
- Three bedrooms
- Easy access to Town Centre
- Generous living accommodation
- Off road parking

GROUND FLOOR

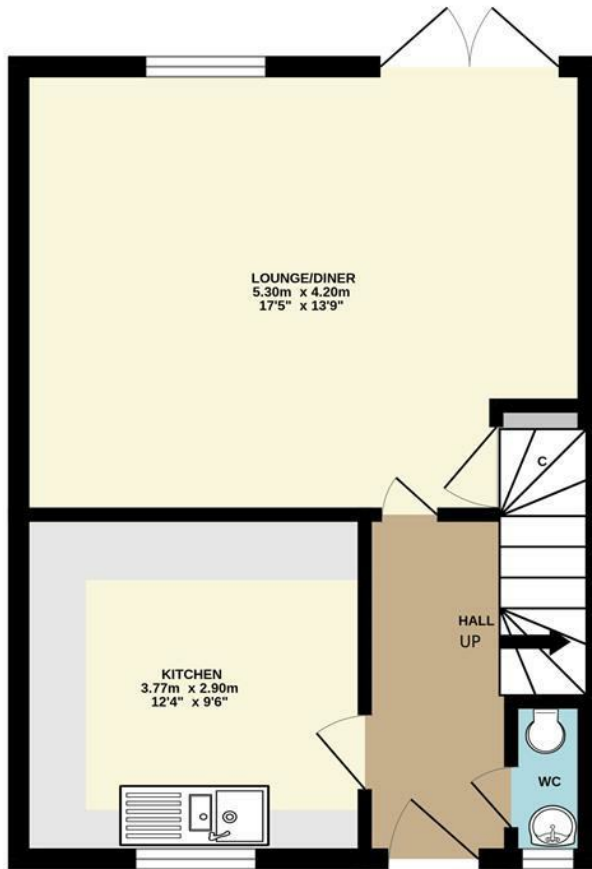

FIRST FLOOR

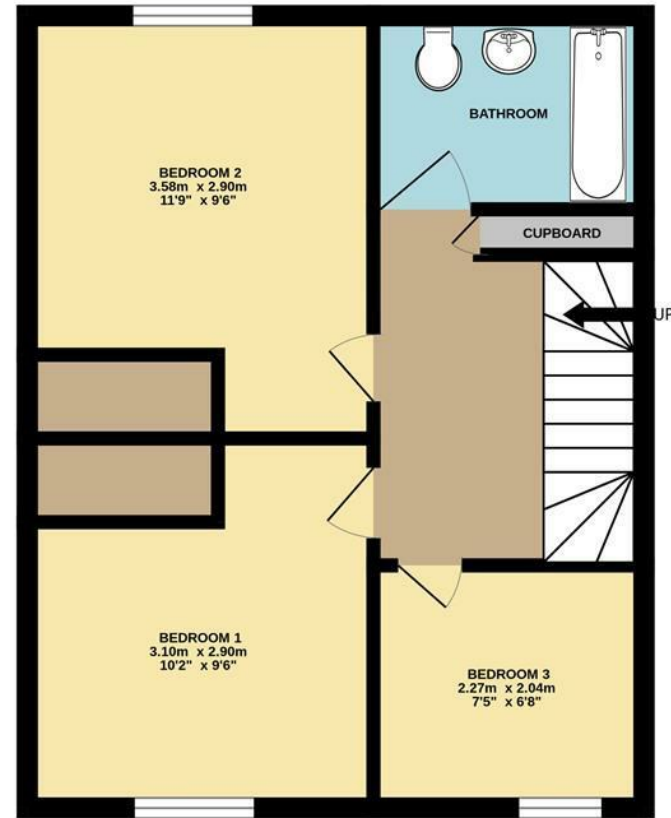

Whilst every attempt has been made to ensure the accuracy of the floorplan contained here, measurements of doors, windows, rooms and any other items are approximate and no responsibility is taken for any error, omission or mis-statement. This plan is for illustrative purposes only and should be used as such by any prospective purchaser. The services, systems and appliances shown have not been tested and no guarantee as to their operability or efficiency can be given.  
Made with Metropix ©2024

Let's talk

01603 660000

sales@abbotfox.co.uk

@abbotfox

EPC RATING -

Disclaimer – In accordance with the Property Misdescriptions Act, the company abbotFox gives notice that all descriptions, references to condition, necessary permissions for use and other details are given in good faith and believed to be correct, but any purchaser should not rely on them as statements of fact, and must satisfy themselves by inspection or other means, as to their accuracy.